

COLOR CODING KEY:

- EXISTING FURNITURE
- NEW FURNITURE
- FURNITURE - BY OWNER

NEW FURNITURE PLAN - FLOOR 4

3027 - 1'-0"

NEW FURNITURE PLAN - FLOOR 4 (SHEET 1 OF 3)

UNITED STATES COURT OF APPEALS FOR THE SIXTH CIRCUIT | NON-RESIDENT JUDICIAL CHAMBER FURNITURE



APRIL 2017

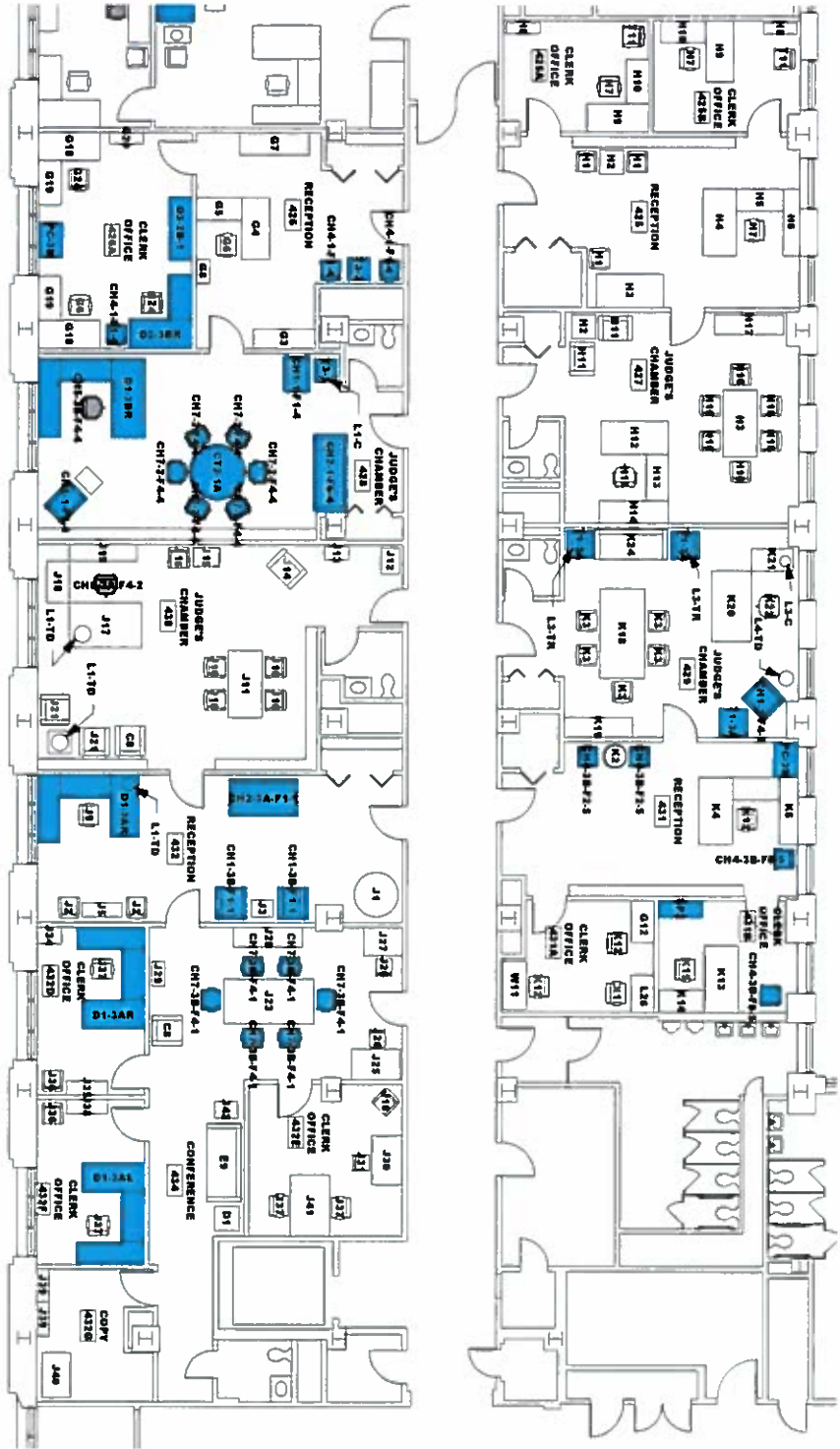

COLOR CODING KEY:

- EXISTING FURNITURE
- NEW FURNITURE
- FURNITURE - BY OWNER

NEW FURNITURE PLAN - FLOOR 4

3/27' - 1'-0"

NEW FURNITURE PLAN - FLOOR 4 (SHEET 2 OF 3)

UNITED STATES COURT OF APPEALS FOR THE SIXTH CIRCUIT | NON-RESIDENT JUDICIAL CHAMBER FURNITURE

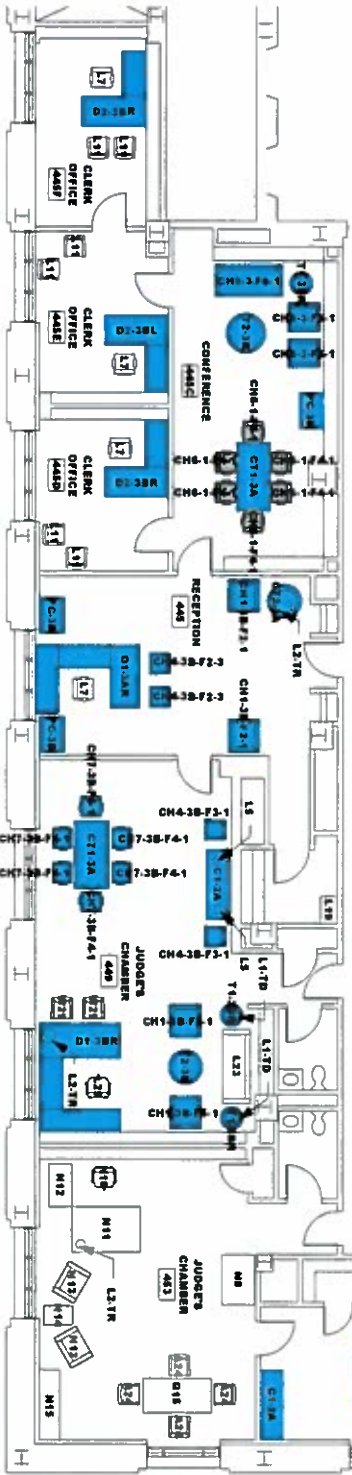
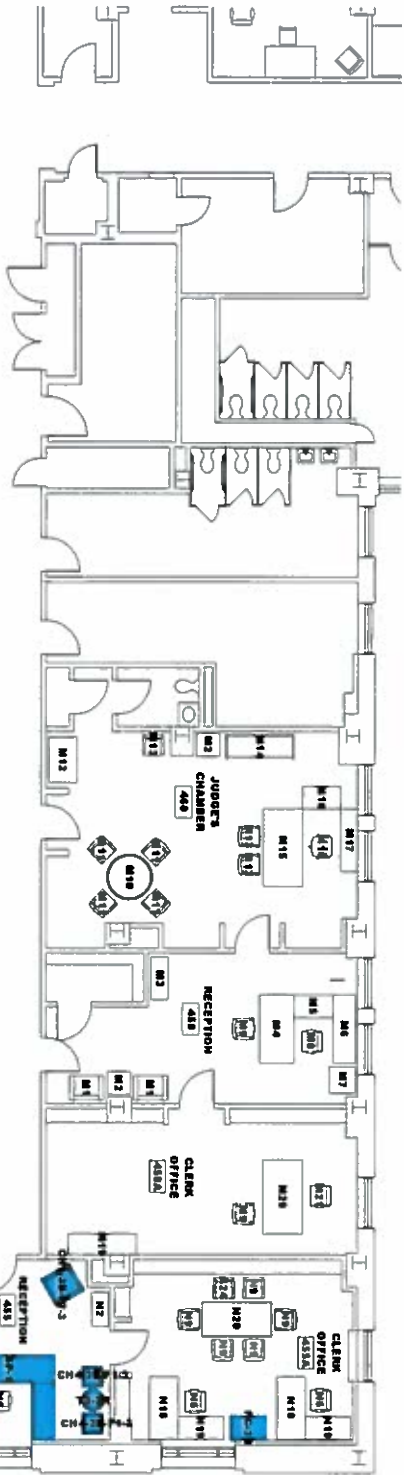

- COLOR CODING KEY:**
- EXISTING FURNITURE
 - NEW FURNITURE
 - FURNITURE - BY OWNER

NEW FURNITURE PLAN - FLOOR 4

3/27 - 1'-0"

NEW FURNITURE PLAN - FLOOR 4 (SHEET 3 OF 3)

UNITED STATES COURT OF APPEALS FOR THE SIXTH CIRCUIT | NON-RESIDENT JUDICIAL CHAMBER FURNITURE

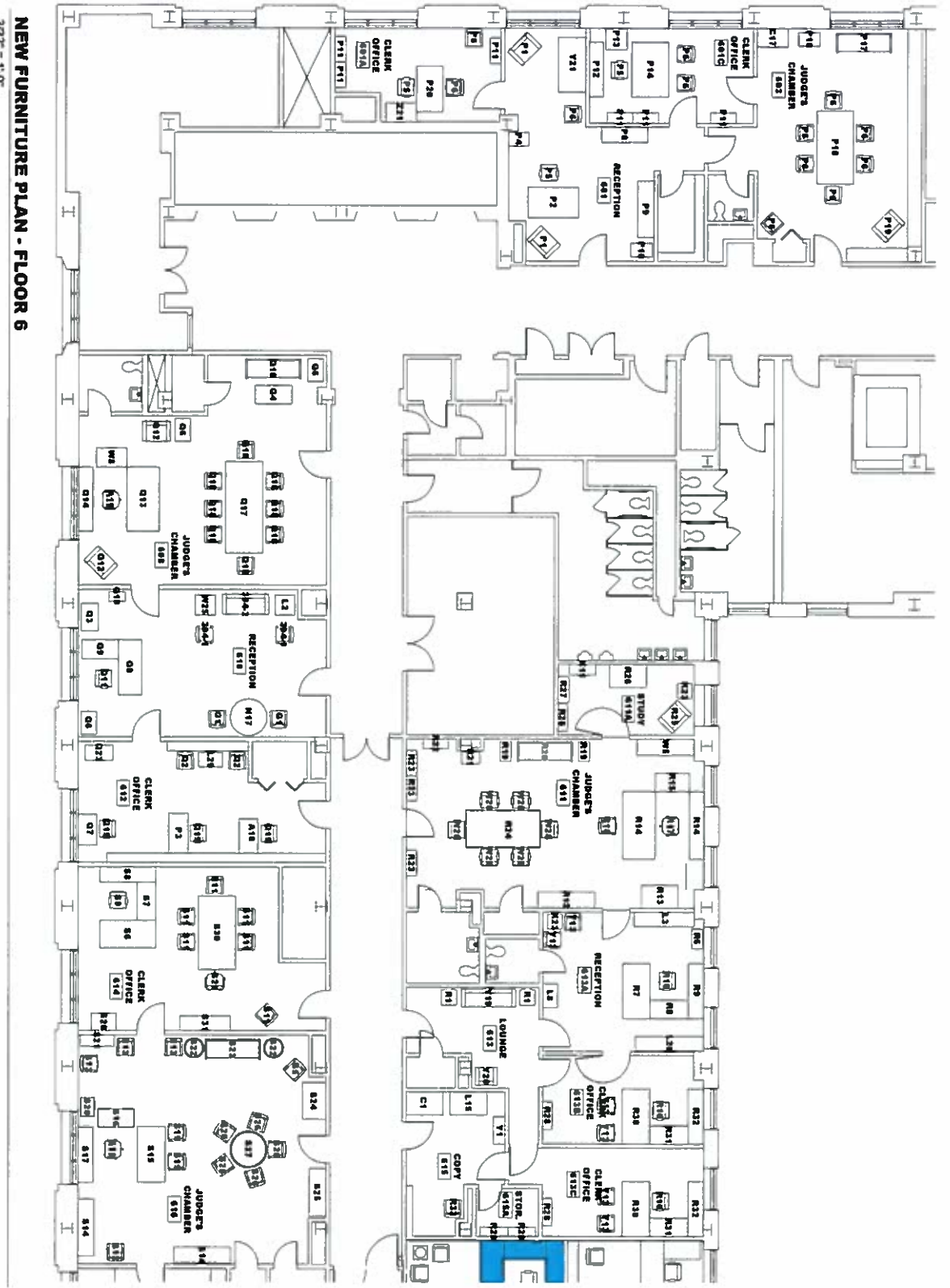

NEW FURNITURE PLAN - FLOOR 6

NEW FURNITURE PLAN - FLOOR 6 (SHEET 1 OF 3)

UNITED STATES COURT OF APPEALS FOR THE SIXTH CIRCUIT | NON-RESIDENT JUDICIAL CHAMBER FURNITURE

COLOR CODING KEY:

- EXISTING FURNITURE
- NEW FURNITURE
- FURNITURE - BY OWNER

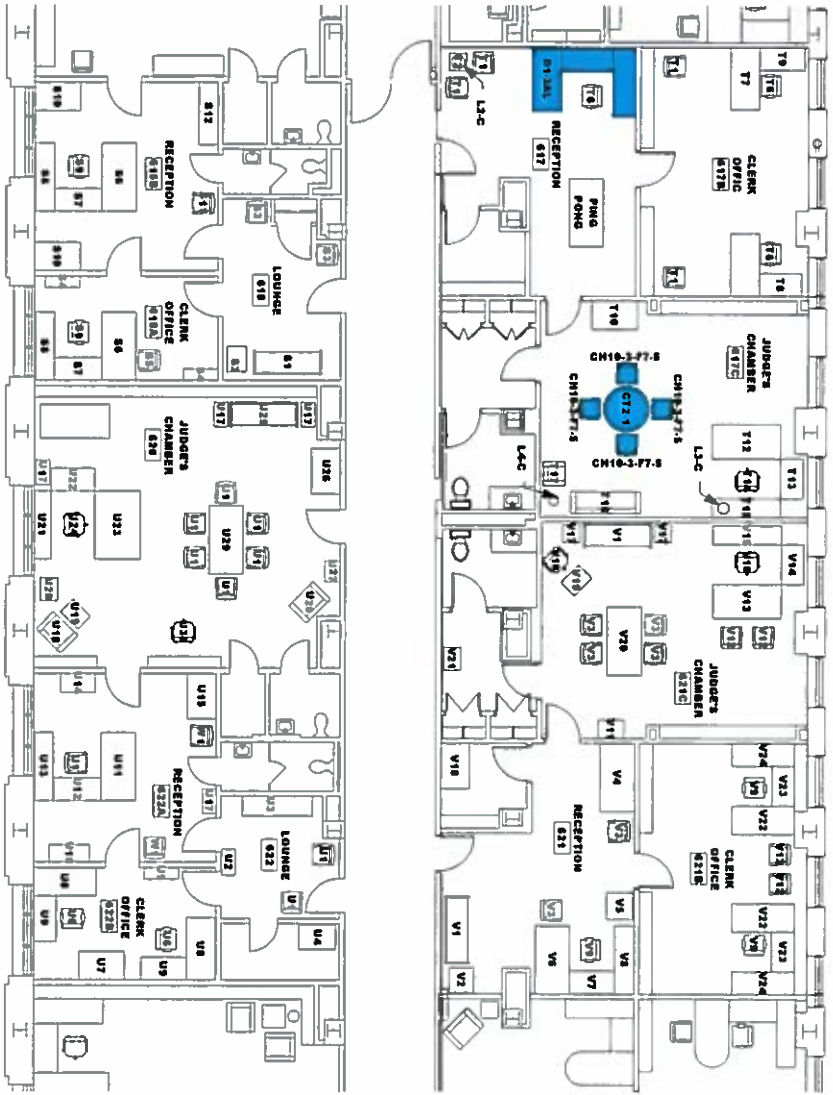

- COLOR CODING KEY:**
- EXISTING FURNITURE
 - NEW FURNITURE
 - FURNITURE - BY OWNER

NEW FURNITURE PLAN - FLOOR 6

30'x' = 1'-0"

NEW FURNITURE PLAN - FLOOR 6 (SHEET 2 OF 3)

UNITED STATES COURT OF APPEALS FOR THE SIXTH CIRCUIT | NON-RESIDENT JUDICIAL CHAMBER FURNITURE



COLOR CODING KEY:

- EXISTING FURNITURE
- NEW FURNITURE
- FURNITURE - BY OWNER

NEW FURNITURE PLAN - FLOOR 6

3/27 = 1'-0"

NEW FURNITURE PLAN - FLOOR 6 (SHEET 3 OF 3)

UNITED STATES COURT OF APPEALS FOR THE SIXTH CIRCUIT | NON-RESIDENT JUDICIAL CHAMBER FURNITURE